

Service Kit Instructions

Toilet Flush Valve

Français, page “Français-1”
Español, página “Español-1”

THE BOLD LOOK
OF **KOHLER**®

1333505-9-B

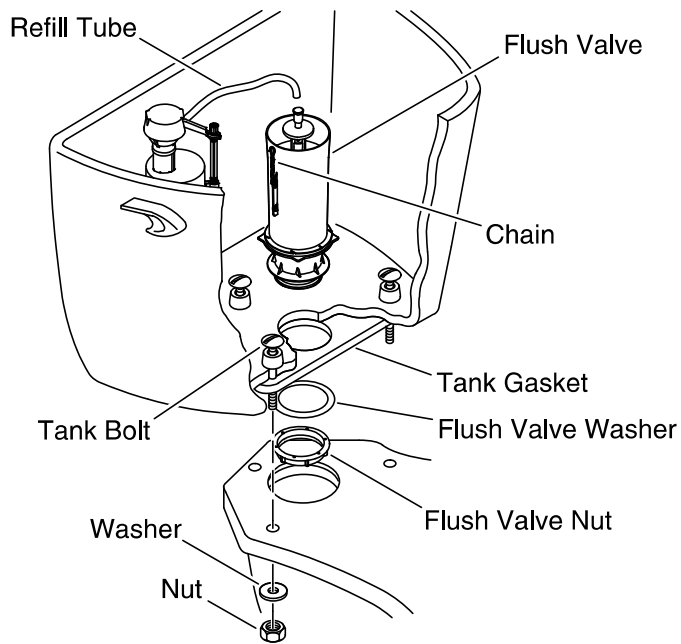

1. Remove the Flush Valve

NOTICE: Make sure that you have the correct flush valve for your toilet model. The model number is located inside the tank. For more information, visit kohler.com/serviceparts and enter your model number.

NOTE: Your flush valve may appear different than the one shown.

- ☐ Turn off the water supply.
- ☐ Remove the tank cover.
- ☐ Flush the toilet. Repeat until empty. Sponge out any remaining water. Disconnect the water supply.
- ☐ Disconnect the trip lever chain.
- ☐ Disconnect the refill tube.
- ☐ Remove the nuts and washers from the tank bolts. Remove the tank.
- ☐ Turn the flush valve nut counterclockwise to remove the flush valve.

Remove the Flush Valve (cont.)

- Remove and discard the old tank bolts, flush valve washer, tank gasket, and flush valve.

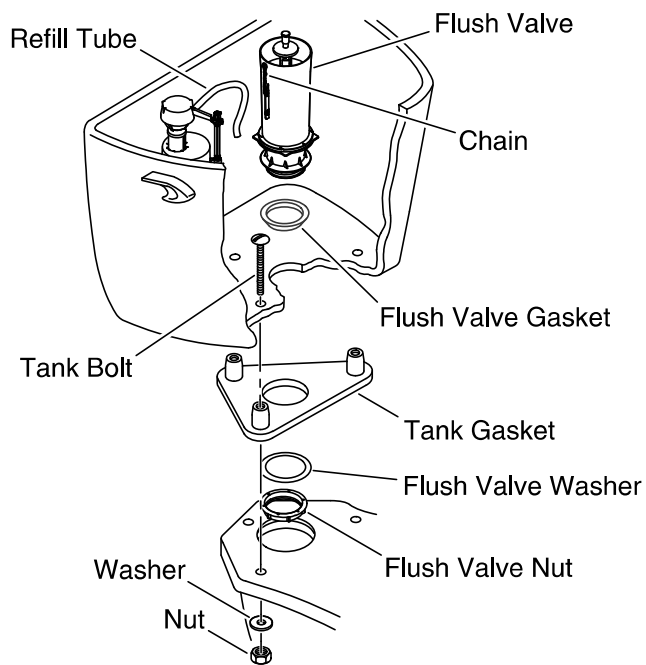

2. Install the Flush Valve

- ❑ Install the new tank gasket to the bottom of the tank.
- ❑ Install the flush valve gasket to the new flush valve.
- ❑ Insert the new flush valve through the tank hole.
- ❑ From underneath the tank, install the flush valve washer and flush valve nut onto the bottom of the flush valve. Handtighten the nut, then tighten an additional one-quarter turn.
- ❑ Position the tank on the bowl by centering the tank gasket over the bowl inlet.
- ❑ Install a tank bolt into each hole on the tank gasket.
- ❑ Assemble a washer and nut onto each tank bolt. Alternately tighten the nuts so the tank is level.
- ❑ Be sure that the nuts are tight enough to achieve a watertight seal. **Do not overtighten.**
- ❑ Reconnect the trip lever chain and refill tube.
- ❑ Turn on the water supply. Check for leaks immediately and several times during the next 2 days.