

# Service Kit Instructions

## Touchless Faucet Diaphragm

Français, page “Français-1”  
Español, página “Español-1”

THE BOLD LOOK  
OF **KOHLER**®

1359645-9-A

## Tools and Materials

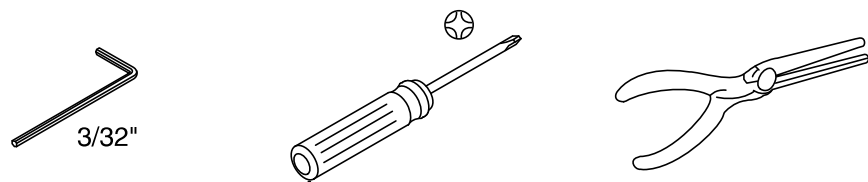

## Before You Begin

- ☐ Shut OFF the water supply.
- ☐ The product shown may differ from your actual product. The steps still apply.

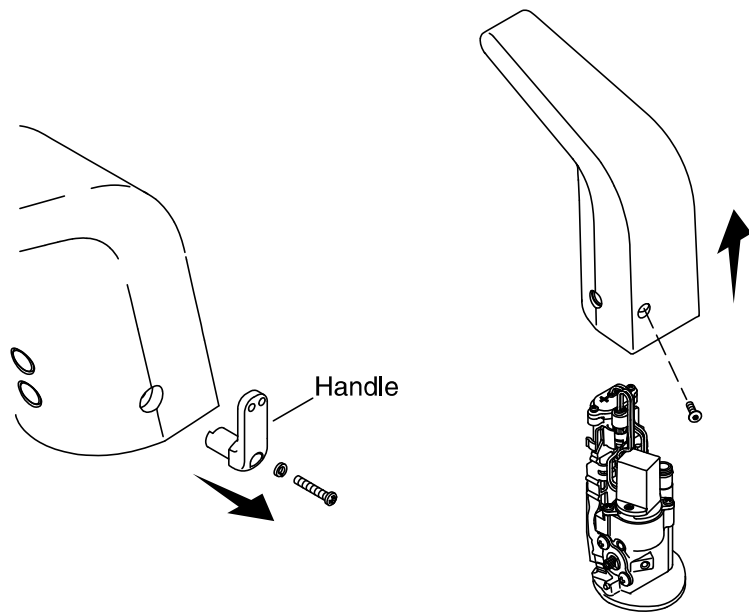

## 1. Remove the Spout

- Turn ON the faucet to relieve pressure.

**NOTE:** Cover the drain to avoid losing small parts.

- Note the orientation of the handle (if present). Unthread the screw and remove the washer and handle.
- Unthread the screw from the back of the faucet.

**IMPORTANT!** Avoid scratching the sensor when removing the spout.

- Slide the spout forward and off the body.

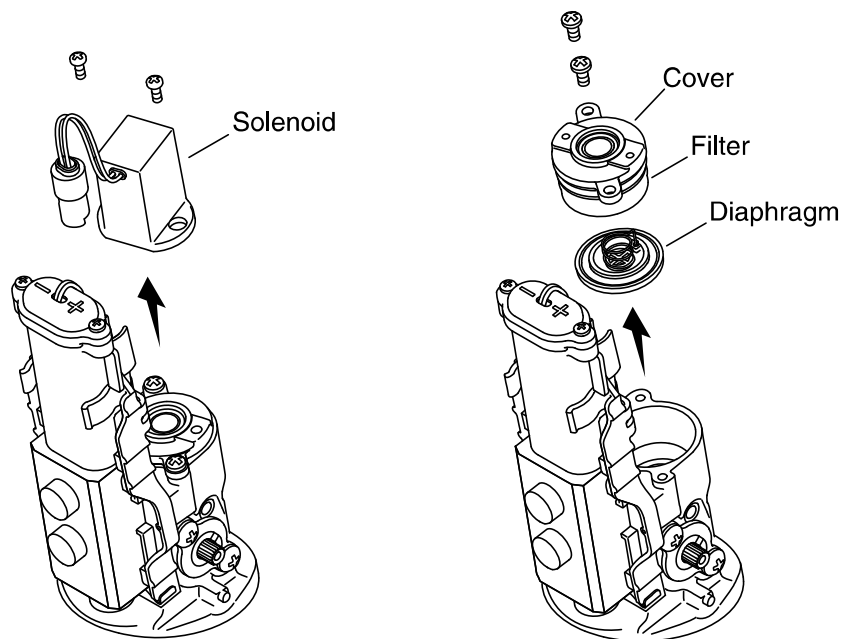

## 2. Remove the Old Diaphragm

- ☐ Disconnect the solenoid wire.
- ☐ Unthread the two solenoid screws. Remove the solenoid.
- ☐ Inspect the solenoid for debris. Clean if necessary.
- ☐ Unthread the two cover screws. Remove and discard the old cover and filter.
- ☐ Using a needlenose pliers, remove and discard the old diaphragm.
- ☐ Inspect the valve holes for debris. Clean if necessary.

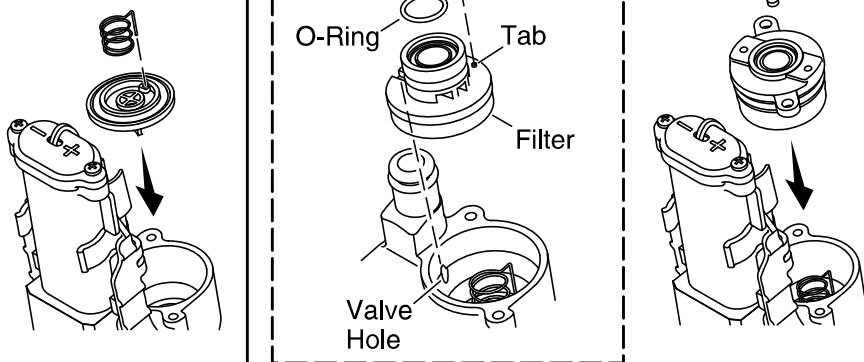

### 3. Install the New Diaphragm

- ☐ Align the spring pin with the diaphragm hole. Snap the spring into place.
- ☐ Insert the diaphragm into the valve body.
- ☐ Insert the O-ring into the filter.
- ☐ Align the tab on the filter with the hole in the cover. Twist together until the tab is properly seated.
- ☐ Align the filter port with the valve hole, then insert the cover/filter assembly into the valve body.
- ☐ Secure the cover with the two screws.
- ☐ Reinstall the solenoid and reconnect the solenoid wire.

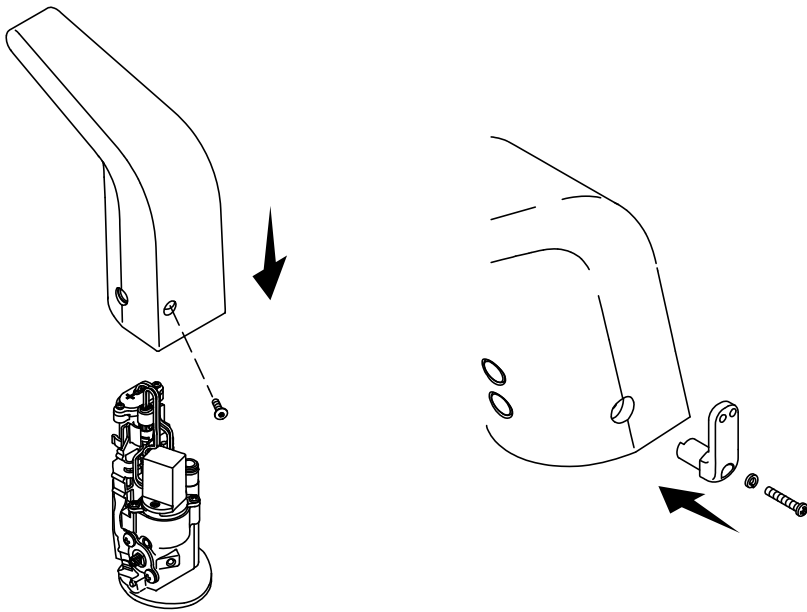

#### 4. Reinstall the Spout

**IMPORTANT!** Avoid scratching the sensor when positioning the spout.

- ☐ Position the spout over the valve, and secure with the screw.
- ☐ Reinstall the handle (if present) in the previously noted orientation.
- ☐ Turn ON the water supply and check for leaks.