

# Cash Acme™

## VB-222 Vacuum Breaker

The VB-222 vacuum breaker valve is designed to prevent dangerous back-siphonage and backflow into a potable water supply system. It automatically self-drains when all attachments are removed completely from the valve's outlet which protects the valve and faucet from freezing and rupturing in cold weather.

### Approved Applications

For use around homes, schools, commercial buildings, laboratories or any application involving a removable hose attached to threaded faucets.

### Specification Data

#### Performance

Maximum Temperature	180°F (82.2°C)
Maximum Pressure	125 psi
Service	Water

#### Materials

1	Body	Brass
2	Pusher Post	Acetal Copolymer
3	Spring	Stainless Steel
4	Seat Disc	Buna-N
5	O-ring	Buna-N

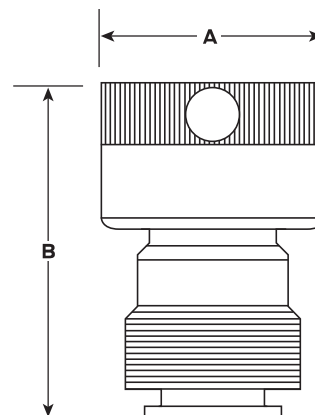

#### Dimensions (inches)

Size	Connection Style	Part #	Lead Free	Finish	A	B
3/4"	NH Threaded w/ Locking Screw	19600-0000LF	Y	Brass	5-3/32	2-7/16
3/4"	NH Threaded w/ Locking Screw	21896-0000LF	Y	Chrome	5-3/32	2-7/16
3/4"	NH Threaded w/ Locking Screw	19600-0000		Brass	5-3/32	2-7/16
3/4"	NH Threaded w/ Locking Screw	21896-0000		Chrome	5-3/32	2-7/16

### Certifications & Listings

ASSE 1011, CSA B.64.1.1, NSF/ANSI/CAN 61, NSF/ANSI/CAN 372



Refer to local plumbing code

#### Product Submittal

Name	
Date	
Architect/Owner	
Contractor	
Tag	
Notes	

